



STAGE SERIES LIGHT BARS

XM0055G

Whether you are hitting the trails at night or just going off the beaten path, being able to see what obstacles lie ahead is a must. That's where LED off road lights can make a huge difference! Stage Series light bars are a great way to easily add more light output to the area in front of your off road vehicle. Here at Diode Dynamics, we offer premium on or off road light bars with a highly-efficient, useful beam pattern in a durable, compact package. No matter what your auxiliary lighting needs are, there is a Stage Series light bar for you!

We also offer a variety of vehicle-specific brackets and kits. See the inside of this brochure or visit www.diodedynamics.com for a full list of our light bar kits!

STAGE SERIES

RALLY-QUALIFIED LED LIGHTING

STAGE SERIES LIGHT BARS

Introducing STAGE SERIES LED lighting! Inspired by the needs of a professional rally driver, these light bars have been designed for maximum functionality, with compact size, custom-engineered TIR optics, and a useful beam pattern, all in a highly durable package.

Thanks to the high-intensity Lumileds LED chips, coupled with our Total Internal Reflection (TIR) optic, the Stage Series directs light only where you need it, drastically reducing glare and improving total efficiency—making it perfect for directing light downrange on winding trails when driving at high speeds!



OUTPUT

The Stage Series LED Light Bars were designed to create a highly efficient beam pattern with minimal glare! While other light bars may lose light internally and create more glare, our new TIR optics collect all the light from the LED chips and effectively focus the output down the road where you need it!



**COMPUTER DESIGNED
OEM FITMENT**

Our Stage Series application-specific light bar brackets were CAD-designed for perfect fitment and OEM-like appearance. These brackets utilize existing mounting points for easy installation - no cutting or drilling required!



DIODE DYNAMICS
PERFORMANCE LIGHTING TECHNOLOGY

(314) 205-3033
contact@diodedynamics.com
www.diodedynamics.com



HIGH INTENSITY | FOCUSED OUTPUT | SLIM DESIGN

DIODE DYNAMICS
PERFORMANCE LIGHTING TECHNOLOGY

PRICING

		DRIVING	WIDE	FLOOD	COMBO
SS ₆	\$120	X	X	X	
SS ₁₂	\$200	X	X	X	
SS ₁₈	\$280	X		X	X
SS ₃₀	\$440	X		X	X
SS ₄₂	\$560	X		X	X
SS ₅₀	\$640	X		X	X

STAGE SERIES

RALLY-QUALIFIED LED LIGHTING

TAKE A LOOK INSIDE

Total Internal Reflection (TIR) Optics

Patent-Pending TIR optics, or TIR lenses, consist of a refractive lens nestled inside a reflector and are typically cone-shaped with optical efficiencies as high as 92 percent. The lens directs light from the source's center to the reflector, which sends it out in a controlled beam.

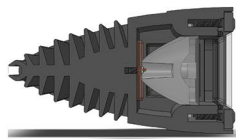

TIR optic side view

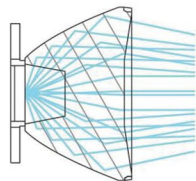

COMPACT

42mm tall, narrow profile to allow hideaway fitment.

HIGH OUTPUT

High-intensity Lumileds Z ES 5700K LED emitters allow excellent optical control, providing more output.

RELIABILITY

Extruded heatsink provides thermal dissipation in a small, durable form factor.

VENTING

Pressure equalizing breather vent to eliminate condensation, by allowing pressure to escape during thermal cycles.

WEATHER-PROOF

Custom-molded gaskets create reliable weatherproof seal around each lens.

DURABILITY

Aluminum extrusion allows for low cost, high performance cooling that can withstand the elements.

LIFESPAN

Metal-core PCBs with direct-solder thermal slugs, to pull heat away from LEDs, allowing them to stay cool in the most demanding conditions.

FUNCTIONAL PATTERNS

Rectangular "driving" pattern by default, far more useful on-road than standard spot. Also available with "wide" fluted or flood lenses.

SIMPLE CONNECTION

Deutsch DT-style connector for high current capacity and compatibility with standard wiring harnesses.

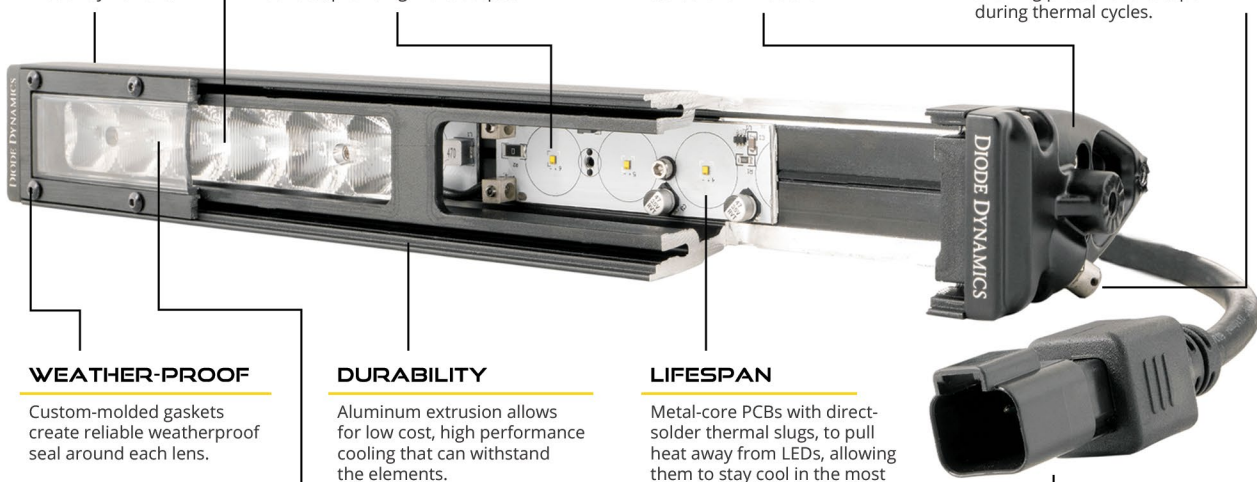

SEE FURTHER.

GO FASTER.



BRACKETS AND KITS

Using our 3D scanner, we measure grilles and bumpers in-house to develop custom mounting solutions with perfect bolt-on fitment. With a durable black electrocoated finish, these steel brackets will securely hold your Stage Series LEDs in discrete locations, for a clean appearance.



STAGE SERIES MOTORSPORTS BRACKET KIT

- Stage Series Motorsports Bracket Kit \$220
- Stage Series 12" Motorsports Light Bar Kit \$1,040
- Stage Series 18" Motorsports Light Bar Kit \$1,360

VEHICLE SPECIFIC KITS:

CHEVROLET COLORADO

- SS30 Stealth Light Bar Bracket Kit 2015-2020 \$80
- SS30 Stealth Light Bar Kit 2015-2020 \$540

DODGE RAM

- Sport/Express SS6 SAE/DOT Light Bar Kit 2013-2018 \$380
- Standard SS6 SAE/DOT Light Bar Kit 2013-2018 \$380

FORD RANGER

- SS6 Light Bar Bracket Kit 2019-2021 \$80
- SS18 Light Bar Bracket Kit 2019-2021 \$40
- SS6 Light Bar Kit 2019-2021 \$320
- SS18 Light Bar Kit 2019-2021 \$350

FORD RAPTOR

- Fog Light Bar Bracket Kit 2017-2020 \$120
- SS6 Fog Light Bar Kit 2017-2020 \$400
- SS12 Fog Light Bar Kit 2017-2020 \$580

FORD SUPER DUTY

- SS6 Fog Light Bar Kit 2020-2022 \$340

GMC CANYON

- SS30 Stealth Light Bar Bracket Kit 2015-2020 \$80
- SS30 Stealth Light Bar Kit 2015-2020 \$540

JEEP JL WRANGLER/GLADIATOR

- SS30 Bumper Light Bar Bracket Kit 2018-2023 \$120
- SS30 Bumper Light Bar Single Kit 2018-2023 \$580
- SS30 Bumper Light Bar Dual Kit 2018-2023 \$840
- Cowl Mount Bracket Kit 2018-2023 \$120
- SS6 Cowl Mount Light Bar Kit 2018-2023 \$400

JEEP JL WRANGLER/GLADIATOR (CONT.)

- Hood Light Bar Bracket Kit 2018-2023 \$50
- SS50 Light Bar Kit 2018-2023 \$710
- SS30 Rear Hardtop Light Bar Kit 2018-2023 (Wrangler) \$490

RAM 1500

- SS18 Stealth Light Bar Bracket Kit 2019-2023 \$100
- SS18 Stealth Light Bar Kit 2019-2023 \$380

SUBARU WRX/STI

- SS6 SAE/DOT Light Bar Kit 2015-2017 \$320

TOYOTA 4RUNNER

- SS6 SAE/DOT Light Bar Bracket Kit 2014-2023 \$80
- SS6 SAE/DOT Light Bar Kit 2014-2023 \$320
- SS30 Stealth Light Bar Bracket Kit 2014-2019 \$120
- SS30 Stealth Light Bar Single Kit 2014-2019 \$560
- SS30 Stealth Light Bar Dual Kit 2014-2019 \$910

TOYOTA TACOMA

- SS30 Stealth Light Bar Bracket Kit 2016-2023 \$80
- SS30 Stealth Light Bar Kit 2016-2023 \$540

TOYOTA TUNDRA

- SS6 LED Fog Light Kit 2022-2023 \$300
- SS12 SAE/DOT Light Bar Kit 2014-2021 \$480
- SS18 Stealth Bumper Light Bar Kit 2022-2023 \$360
- SS18 TRD Pro Grille Light Bar Kit 2022-2023 \$380
- SS30 Stealth Light Bar Kit 2014-2021 \$500
- SS42 Stealth Light Bar Kit 2014-2021 \$620

Visit www.diodedynamics.com for a full list of kits!